

ARTICLE.

VERSION 1.1

Assembly Instructions

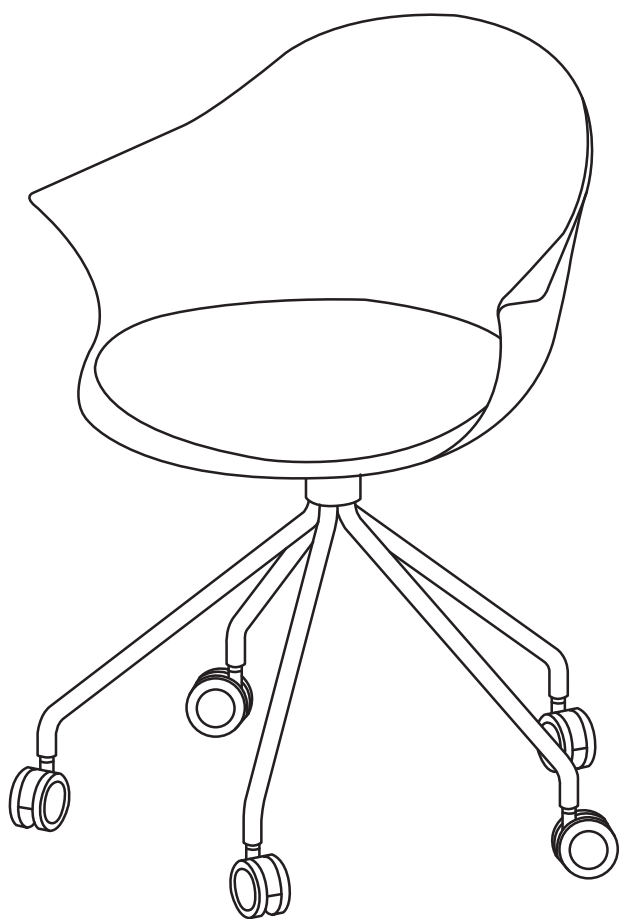

LUMVIG

Office Chair

ASSEMBLY INSTRUCTIONS

Read these instructions carefully and keep for future reference. Refer to parts inventory for guidance, and ensure you have all pieces before starting.

When assembling, place all parts on a soft, clean, and flat surface such as a carpet to prevent scratches.

If you’re having difficulty, our friendly Customer Care team is always here to help. Call us at **1.888.746.3455** during business hours, email **service@article.com** or chat live at **article.com**.



TIME



OF PEOPLE

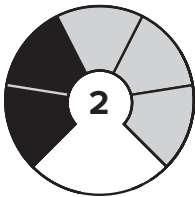

DIFFICULTY

PARTS INVENTORY		
ID	DESCRIPTION	QTY
A	LEGS	1
B	CASTER	5
C	LEG BASE	1
D	SEAT	1
E	SEAT CUSHION	1
F	BOLT (1 SPARE INCLUDED)	13 + 1
G	ALLEN KEY	1

1

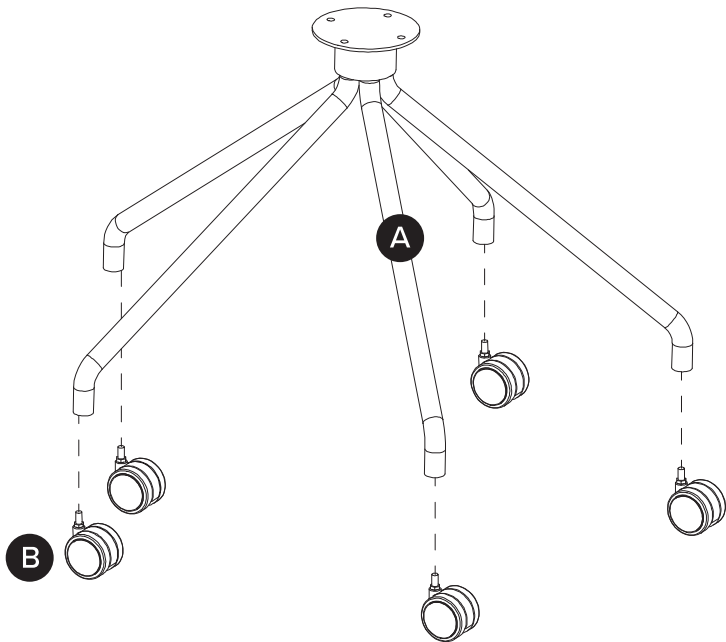

2

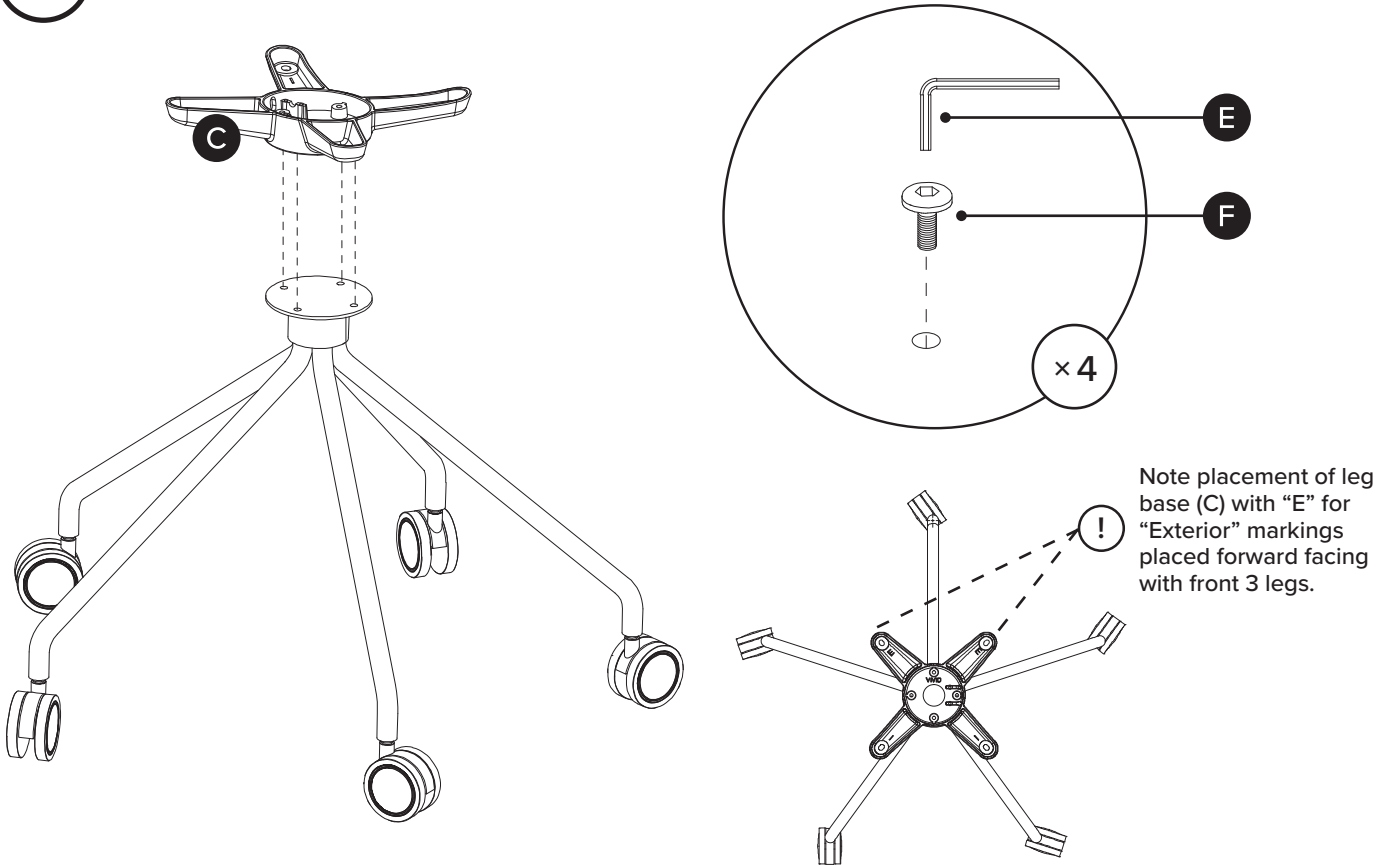

3

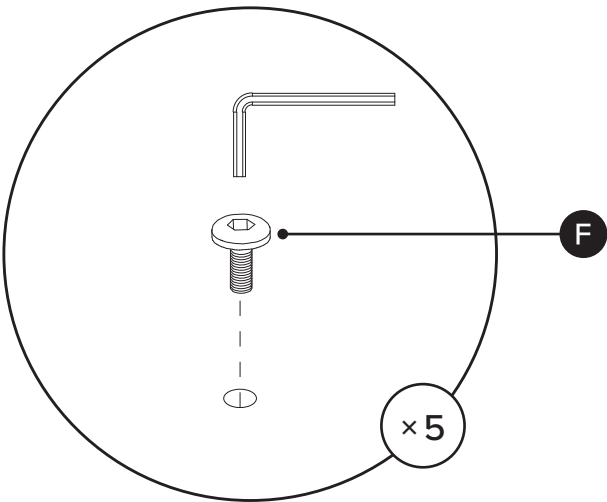
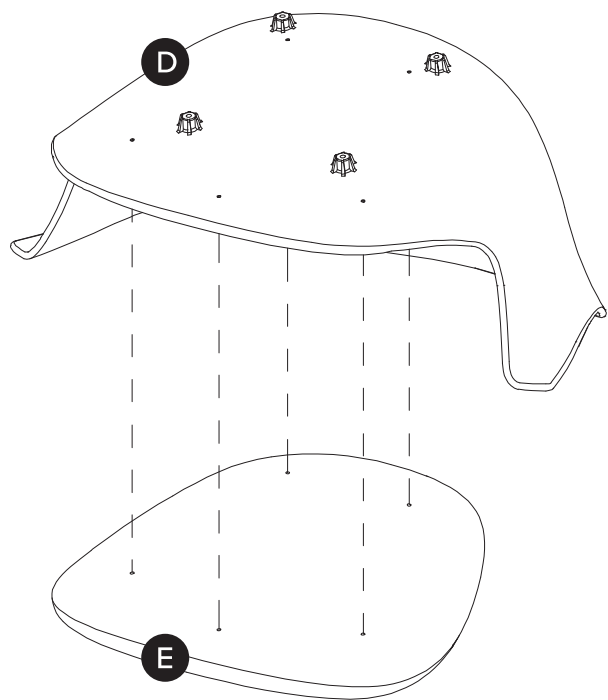

4

Note placement of leg base (C) with "E" for "Exterior" markings placed forward facing on chair seat (D).

