

ARTICLE.

VERSION 1.0

Assembly Instructions

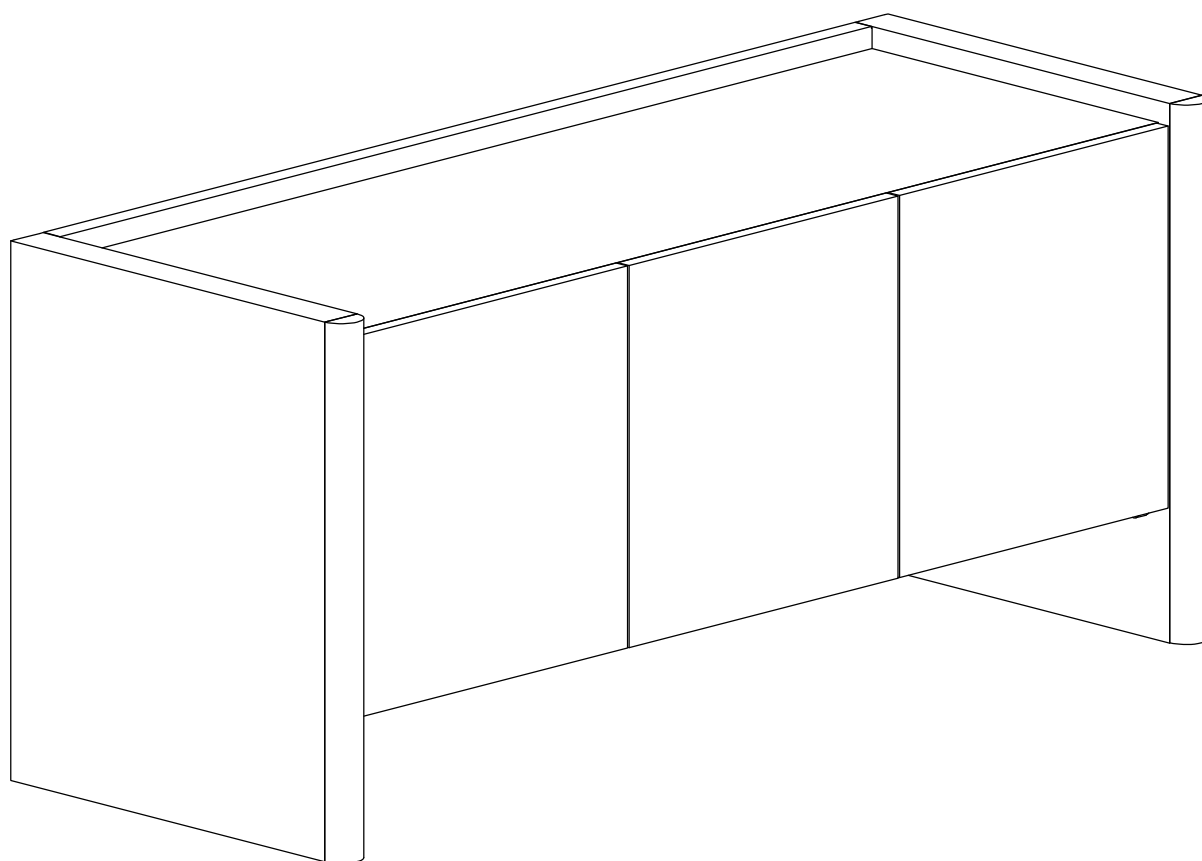

TORME

54" Media Unit

ASSEMBLY INSTRUCTIONS

Read these instructions carefully and keep for future reference. Refer to parts inventory for guidance, and ensure you have all pieces before starting.

When assembling, place all parts on a soft, clean, and flat surface such as a carpet to prevent scratches.

If you’re having difficulty, our friendly Customer Care team is always here to help. Call us at **1.888.746.3455** during business hours, email **service@article.com** or chat live at **article.com**.

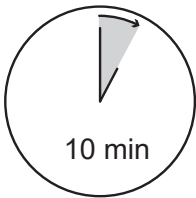

TIME

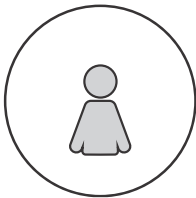

OF PEOPLE

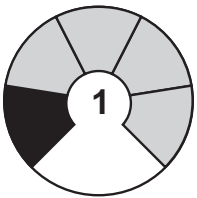

DIFFICULTY

PARTS INVENTORY		
ID	DESCRIPTION	QTY
A	CABINET	1
B	SMALL SHELF	1
C	LARGE SHELF	1

1

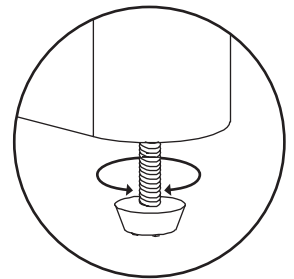
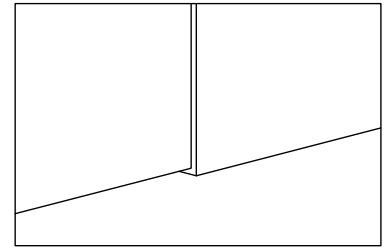
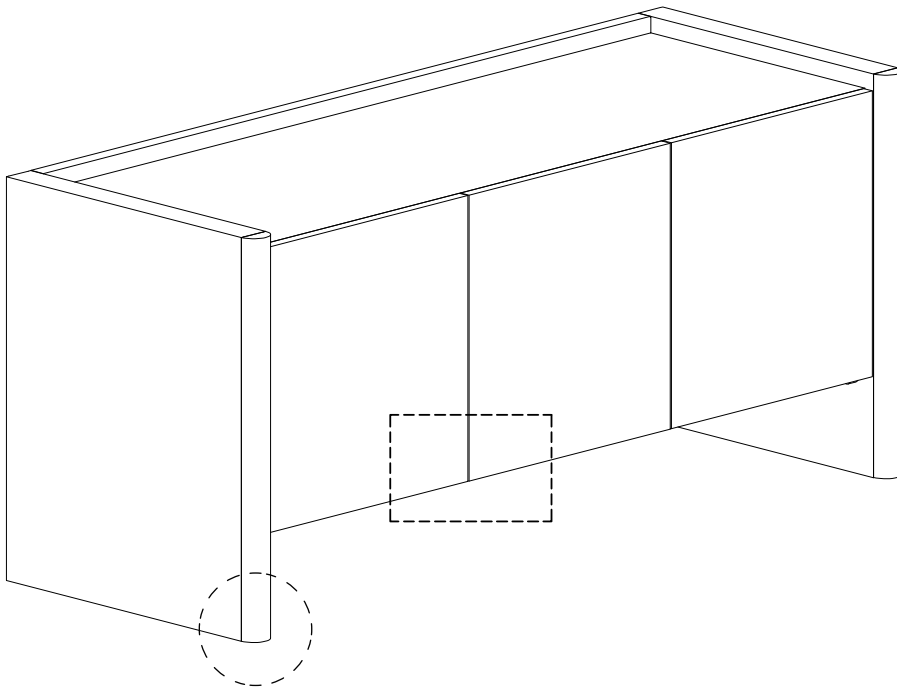

! Adjust levelers as needed.

2

! Remove 02 shelf pins on 1 side first in order to assemble the large shelf.

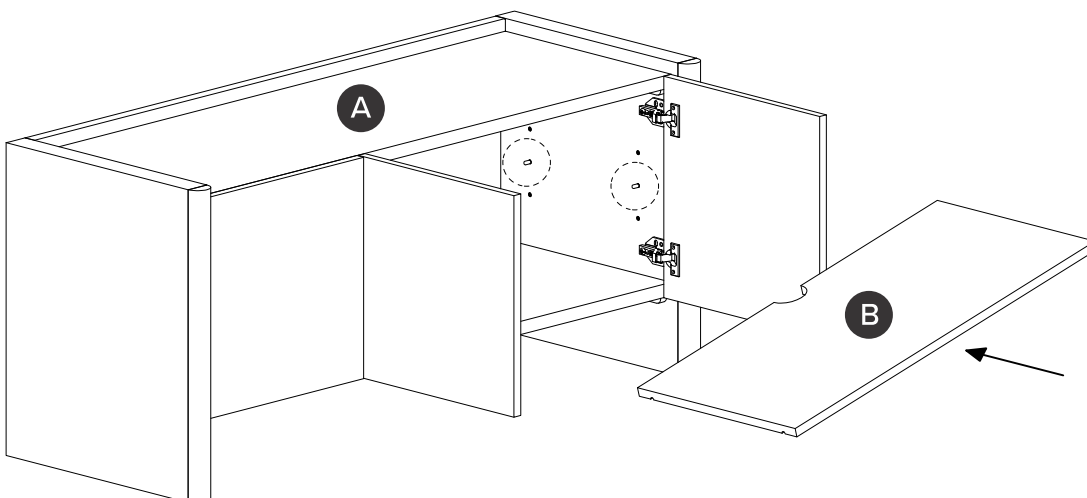
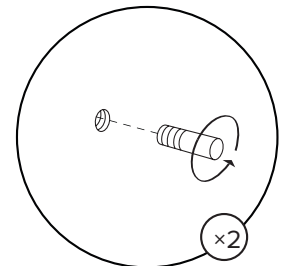

! Change position of shelf as needed.

3

ⓘ Remove 02 shelf pins on 1 side first in order to assemble the small shelf.

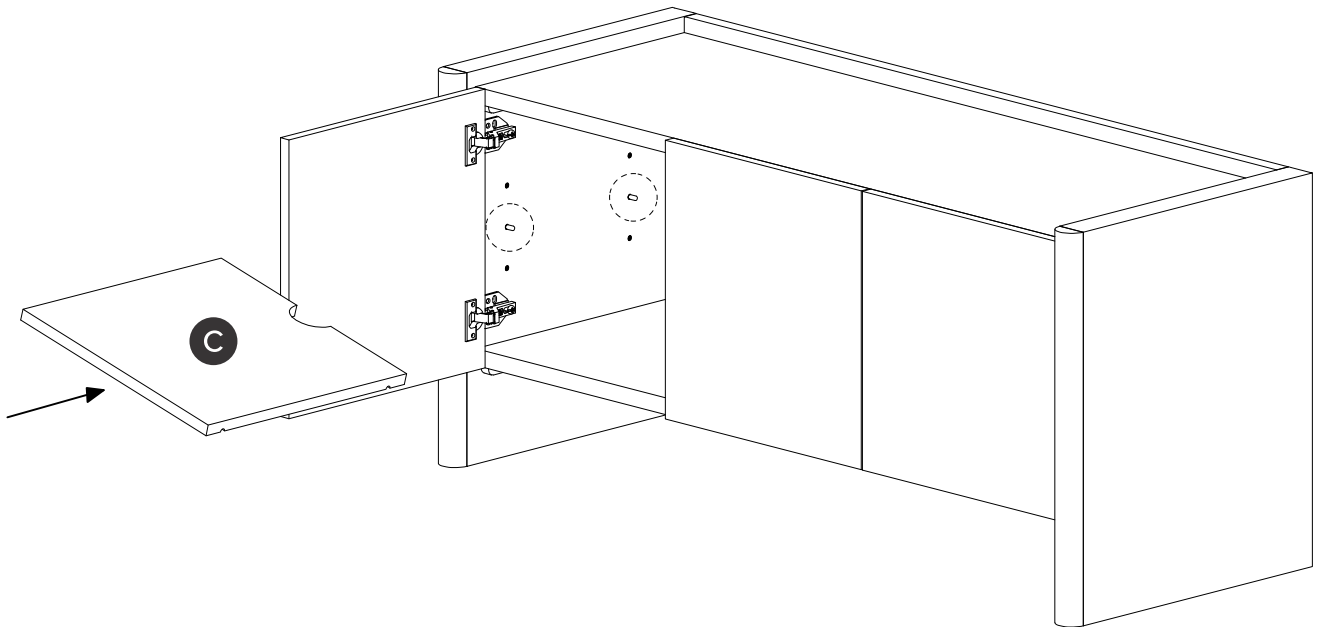
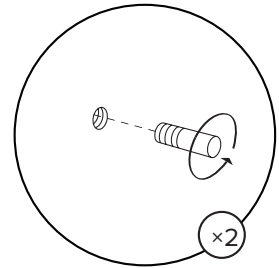

ⓘ Change position of shelf as needed.

DOOR ADJUSTMENT INSTRUCTIONS



During shipping, the doors of your cabinet may have shifted slightly. This can easily be corrected by tightening a few screws. Always start by adjusting the top hinge on the affected door.

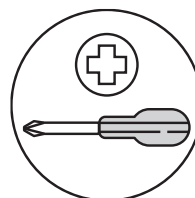

1



If the door needs adjustment side to side:

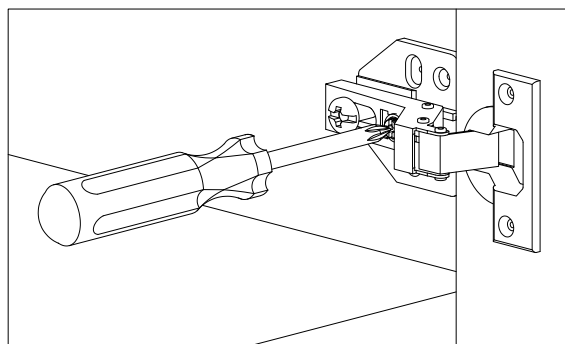
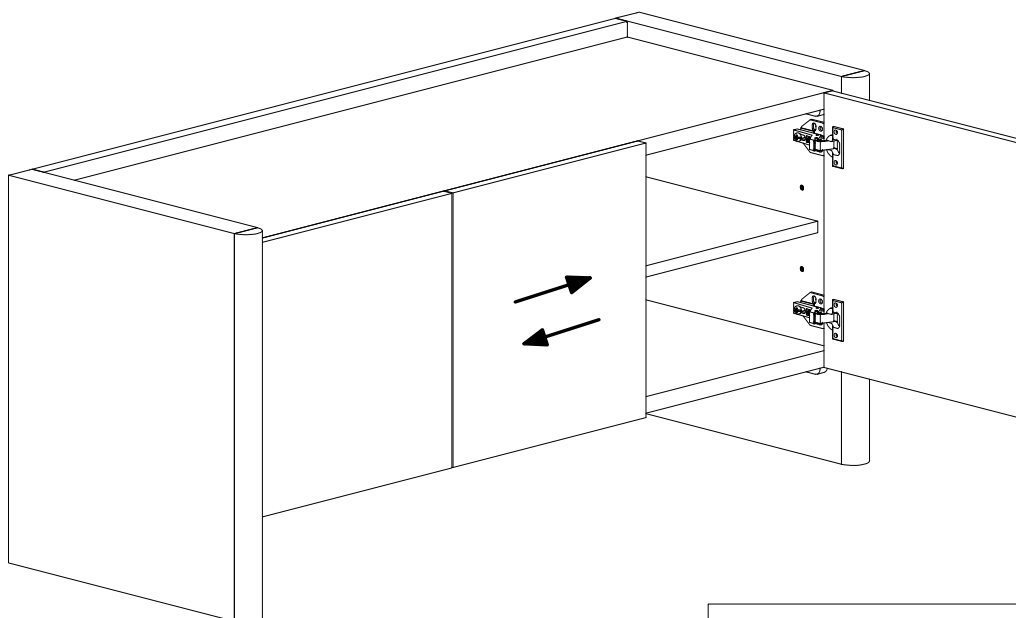

2

! If the door needs adjustment forward or backward:

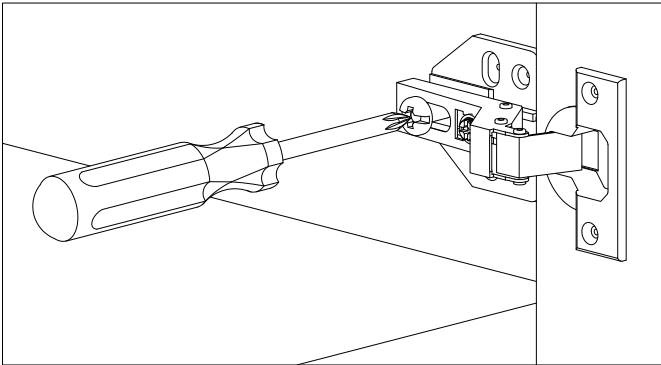
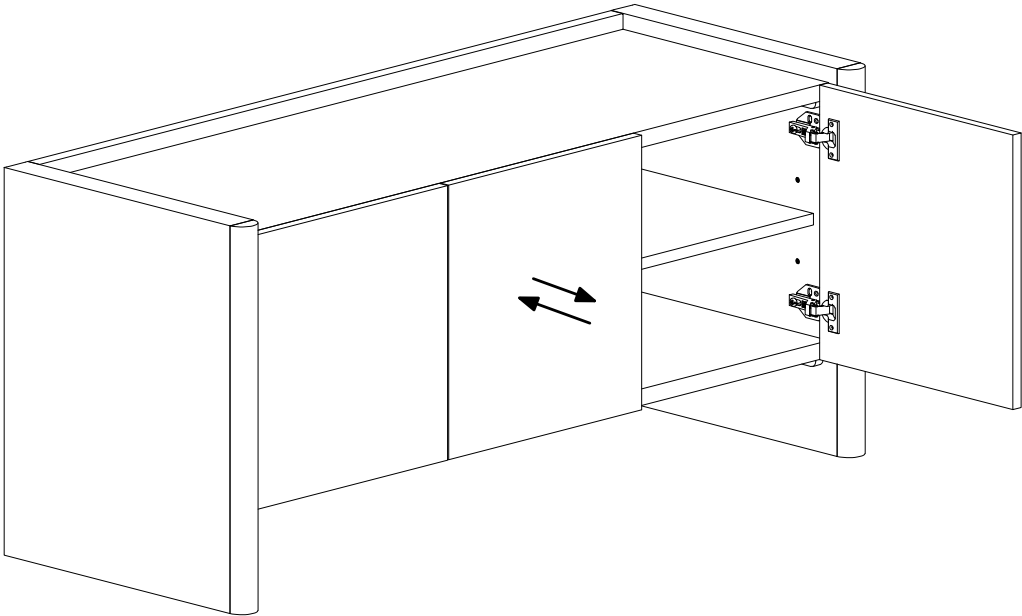

3

! If the door is crooked, adjust hinge(s) up or down:

